

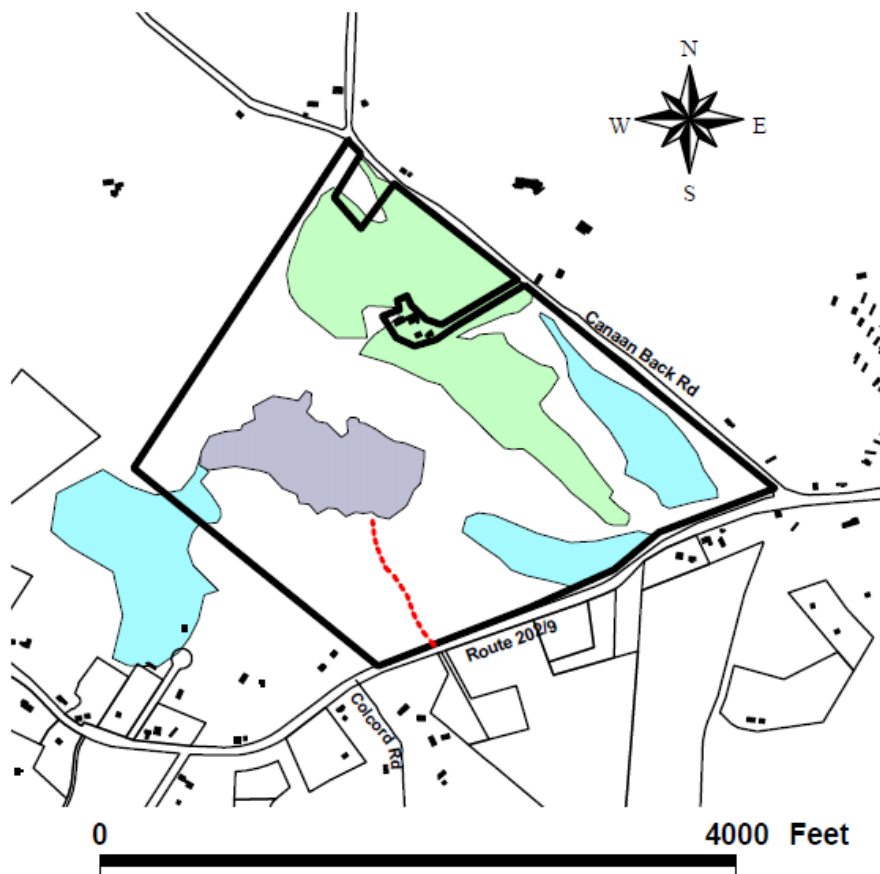





# Boodey Farm



-  Trail to pond
-  Boodey Easement
-  Buildings
-  Fields (no public access)
-  Pond
-  Wetlands

*“Don't let people drive you crazy when you know it's in walking distance.” ~Author Unknown*

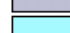
## **BOODEY FARM CONSERVATION EASEMENT**

<b>Trail length:</b>	¼ mile one way
<b>Difficulty:</b>	Easy (may be wet)
<b>Location:</b>	Rtes 9 & 202 & Canaan Back Rd.
<b>Activities:</b>	Hiking, snowshoeing, hunting
<b>Parking:</b>	Difficult. Along the highway, or across from trail on Colcord Rd.
<b>Acreage:</b>	150

The 150-acre Boodey Farm was protected from development via a conservation easement in 1991 with funding from the town of Barrington, the state's LCIP program, and generous donations from the owners and from Jim and Ann Schulz. Ten generations of Boodeys have lived there since 1758!

Although wooded portions of the property are open to the public for passive recreation, hunting, and fishing (but not camping), there is only one short trail/woods road. Since it is a working farm, the fields are off-limits to pedestrians as they are generally occupied by beef cattle and surrounded by an electric fence. Beaver are trapped on the property from October through March, so be cautious for your pets if you venture on to the property in that time frame. Fires and camping are prohibited.

The trailhead is on Routes 202/9 about ½ mile west of Canaan Back Rd. It is only marked via a cable across it to prevent unauthorized vehicles.

The trail leads to a large beaver dam which has impounded the large pond on the property. It contains a heron's nest.